

Sealing Cords DI-SCHN

Diameter from 4 mm to 12 mm



Sealing Cords DI-SCHN

Suitability for industry specific applications

Application

- Sealing cord for production of special, self-made suction plates
- Adaptation of suction plates to the dimensions of special workpieces
- Handling of chipboard and MDF panels with cut-outs

Design

- Wear-resistant sealing cords made of silicone-free foam rubber in various diameters and cross-sections

Product highlights

- Profiled sealing cord in any desired length for the self-construction of suction cups in any requested shape
- Wide range of diameters for the most varied workpieces

Designation code Sealing Cords DI-SCHN

DI-SCHN	–	8	–	MOS EPDM-20	–	SL
1		2		3		4

1 – Abbreviated designation

Code	Version
DI-SCHN	DI-SCHN

2 – Diameter

Code	Diameter in mm
6...12	ø 6 to 12

3 – Material

Code	Material
MOS-EPDM-20	Foam rubber made of ethylene-propylene-caoutchuc

4 – Product addition

Code	Type
SL	Slot

Sealing cord DI-SCHN is delivered in the desired length. Accounting unit 1 m.

Ordering data Sealing Cords DI-SCHN

Type	Part no.
DI-SCHN 4 MOS EPDM-20	10.07.04.00052
DI-SCHN 6 MOS EPDM-20	10.07.04.00001
DI-SCHN 8 MOS EPDM-20	10.07.04.00002
DI-SCHN 8 MOS EPDM-20 SL	10.07.04.00005
DI-SCHN 10 MOS EPDM-20	10.07.04.00003
DI-SCHN 12 MOS EPDM-20	10.07.04.00004

Sealing Cords DI-SCHN

Diameter from 4 mm to 12 mm

 **Technical data Sealing Cords DI-SCHN**

Type	Min. bending radius [mm]	Operating temperature min. [°C]	Operating temperature max. [°C]	Recommended slot width x slot depth [mm]	Length max. [m]
DI-SCHN 6 MOS EPDM-20	10	-25	70	6x4.2	200
DI-SCHN 8 MOS EPDM-20	10	-25	70	8x5.6	200
DI-SCHN 8 MOS EPDM-20 SL	10	-25	70	8x5.6	50
DI-SCHN 10 MOS EPDM-20	10	-25	70	10x7	100
DI-SCHN 12 MOS EPDM-20	10	-25	70	12x8.4	100

Sealing Cords DI-SCHN

Diameter from 4 mm to 12 mm

Design data Sealing Cords DI-SCHN

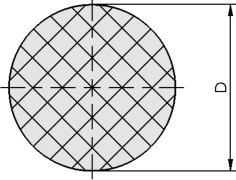

DI-SCHN 6 - 12

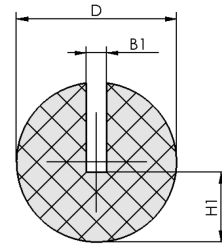

DI-SCHN 8 SL

Sealing Cords DI-SCHN

Diameter from 4 mm to 12 mm

 **Design data Sealing Cords DI-SCHN**

Type*	B1 [mm]	D [mm]	H1 [mm]
DI-SCHN 6 MOS EPDM-20	-	6	-
DI-SCHN 8 MOS EPDM-20	-	8	-
DI-SCHN 8 MOS EPDM-20 SL	1	8	3.5
DI-SCHN 10 MOS EPDM-20	-	10	-
DI-SCHN 12 MOS EPDM-20	-	12	-

*Acceptable dimensional tolerances for rubber parts concerning to DIN ISO 3302-1 E3